



**IMI DEFENSE LTD.**



# **GLOCK PLUS-2 MAGAZINE EXTENSION**

**IMI-G43P2**

## **INSTRUCTION MANUAL**



**Congratulations! You have just purchased the Glock accessories line. Here are its many unique features:**

- **The IMI DEFENSE 43 plus 2 for Glock magazines made from high quality reinforced polymer.**
- **Designed specifically for the Original Glock 43 floor plate.**
- **Available in three colors: black, O.D green and tan.**

**WARNING: Read and understand the entire manual before using. This guide contains Important information on proper assembly, adjustment, handling and use of this product. Usage without reading or otherwise operated may result in serious injury or death. Store the manual in a safe place and review it from time to time. If this guide is lost, contact IMI DEFENSE! Or visit us online at [www.IMIDEFENSE.com](http://www.IMIDEFENSE.com) for a replacement. When using this item, always follow the following precautions:**

- **Use this tool only with the specific weapon for which it is designed. Use of firearms other than that specified may greatly increase the likelihood of accidental discharge or loss of safety features.**
- **Do not use an upgraded floor plate or other accessories that can affect the safe performance of your weapon.**
- **Make sure to carry your weapons in a "SAFE" position (the hammer is not in the back position, selector on "Safe" position).**
- **Never carry any gun with a round in a barrel or in a cocked position, unless you are trained to do so and the gun is designed to be that way.**
- **Do not attempt to repair or change the product in any way. Unauthorized repairs or changes can affect the safe performance of your firearm and will void your warranty.**
- **The user should always practice correct usage.**
- **IMI Defense not responsible for any harm to the sidearm or any user's property.**



## 1. Instructions:

1. Remove all rounds from the magazine.
2. Hold the plate with your thumb (do not let go until the plate is fully removed).
3. Hold the magazine upside down, so the floor plate will be upward.
4. Remove the floor plate from the magazine.
5. Hold the spring plate with your thumb and release it slowly so the spring would not harm anyone until you remove it completely.
6. Insert the spring plate (part 1) inside the spring (make sure it is in the right position).
7. Apply pressure on the plate with your thumb and slide the extension.
- **Important! Do not slide it to the end, watch that the plate jumped inside the extension (if not, help with a small pin).**
8. Close the extension completely.

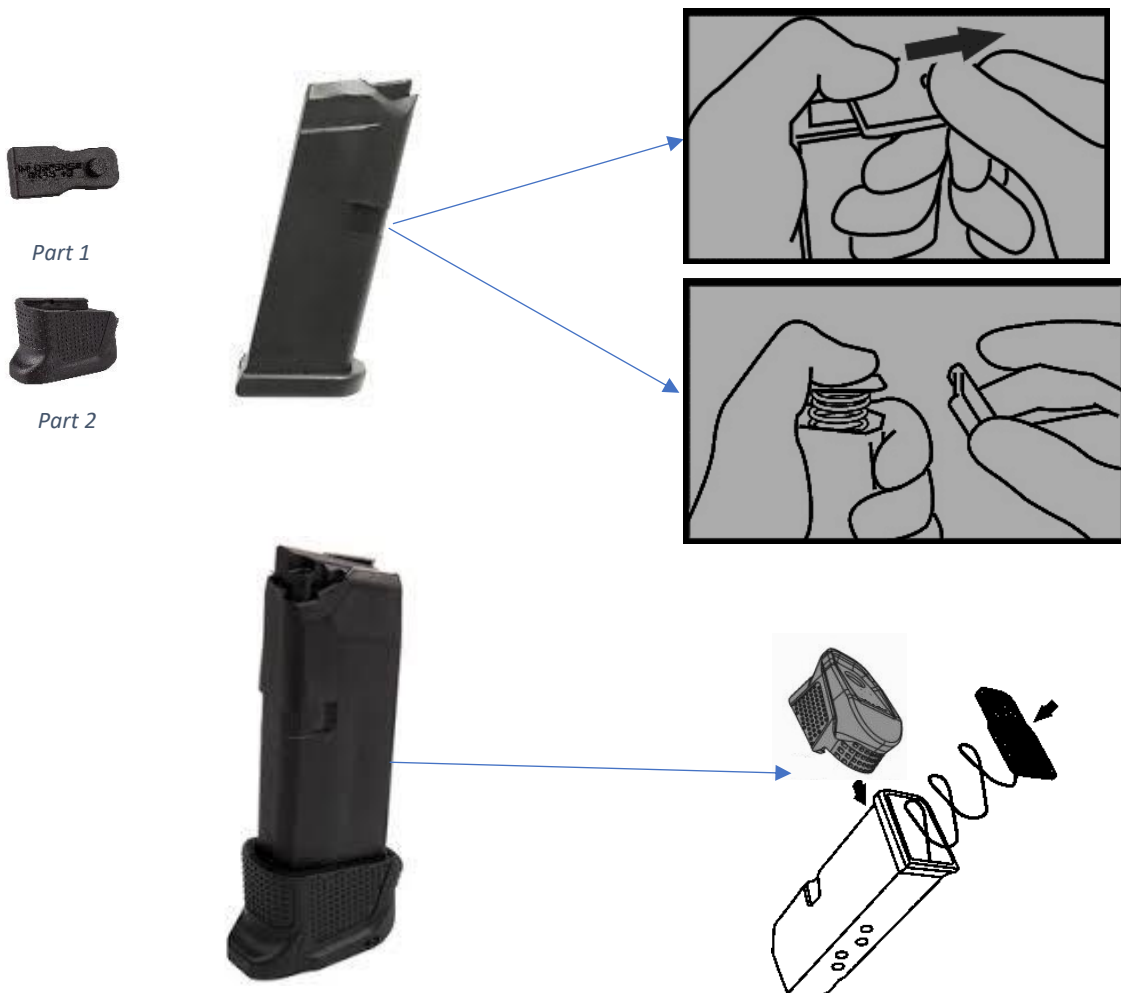



**2. Safety:**

**WARNING: Make sure that your weapon is on "safe" mode before using the product. Make sure the magazine is out of the mag well the pistol has no round in the chamber.**

**Remove all rounds from the magazine.**

**3. Warranty:**

Responsibility for IMI DEFENSE products, including lifespan, for a reasonable use, IMI DEFENSE believes in the quality of its products and believes in the sophisticated production capabilities accumulated over many years.

- **WARNING: Do not modify/repair the product independently, this action can void the warranty.**